

Product Name: Visionary
Process: Select & Direct Print
Material: TriFab & 1/4" Sintra
Effective Date: 10/23/2011

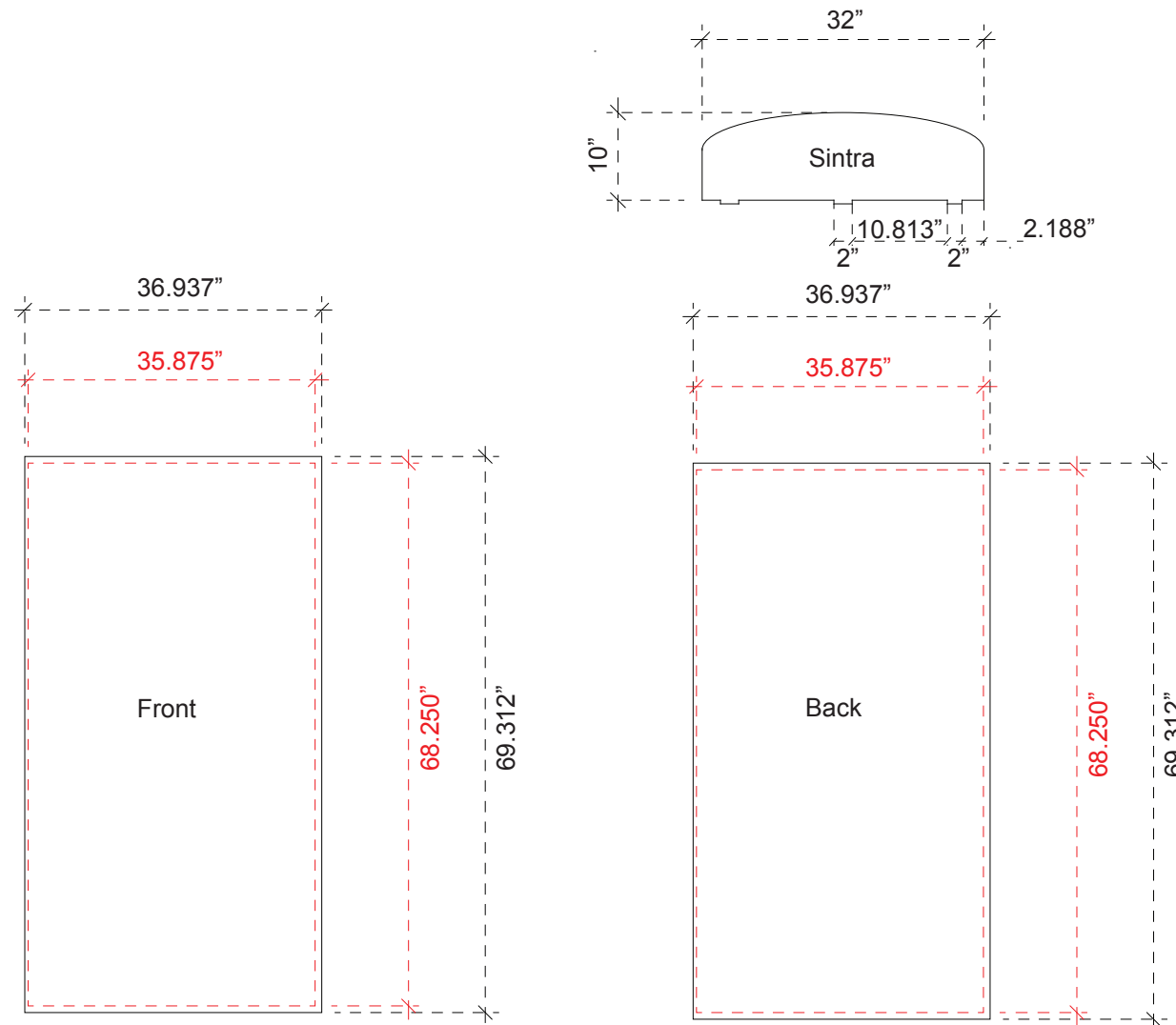

Finished Size: 36.937" w x 69.312" h

Live Area: 35.875" w x 68.250" h

1/2" Silicone Edge around Perimeter

NOTE: Graphic files must be @ 150 dpi Finished Size.
 DO NOT send Flattened Files. Production can not manipulate
 the content, proportion or color of these files.

NOTE: These dimensions are for graphic layout purposes.
 Graphic needs to be cut and test fitted to Visionary frame.